



**CONTACT**

 Dome Solar - 3 rue Marie Anderson  
44 400 Rezé

 +33 (0)2 40 67 92 92

 info@dome-solar.com

 [www.dome-solar.com](http://www.dome-solar.com)



GUARANTEED  
QUALITY

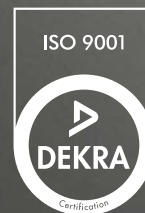

**MOUNTING SYSTEM  
FOR FLAT ROOF WITH  
PVC MEMBRANE**

**ROOF**  **PATENTED  
TECHNIQUE**  
**SOLAR TILTED PVC**

The ROOF-SOLAR TILTED PVC SOLUTION is a photovoltaic mounting system on a waterproofing synthetic PVC membrane (MEPLE), without drilling of the membrane, in a tilted version.

### THE ROOF-SOLAR TILTED PVC ADVANTAGES



#### RELIABILITY

Robust and durable solution, 10 years warranty.  
Compliance with recommendations of clamping module manufacturers.

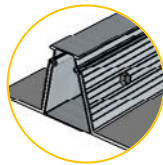

#### SIMPLICITY

The fastening system doesn't require perforating the membrane. Easy and quick implementation of the tilted structure: it can be assembled before the installation on the roof, it is light, very handy and can be fixed to the rail in just seconds.

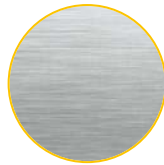

#### QUALITY

Premium aluminum and stainless-steel components. Holding strips from well-known brands recognized from their expertise.



#### ADAPTABILITY

External clamps.

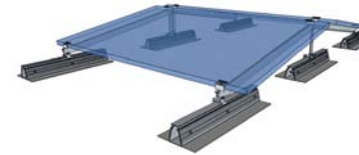

Another possible use : double shed

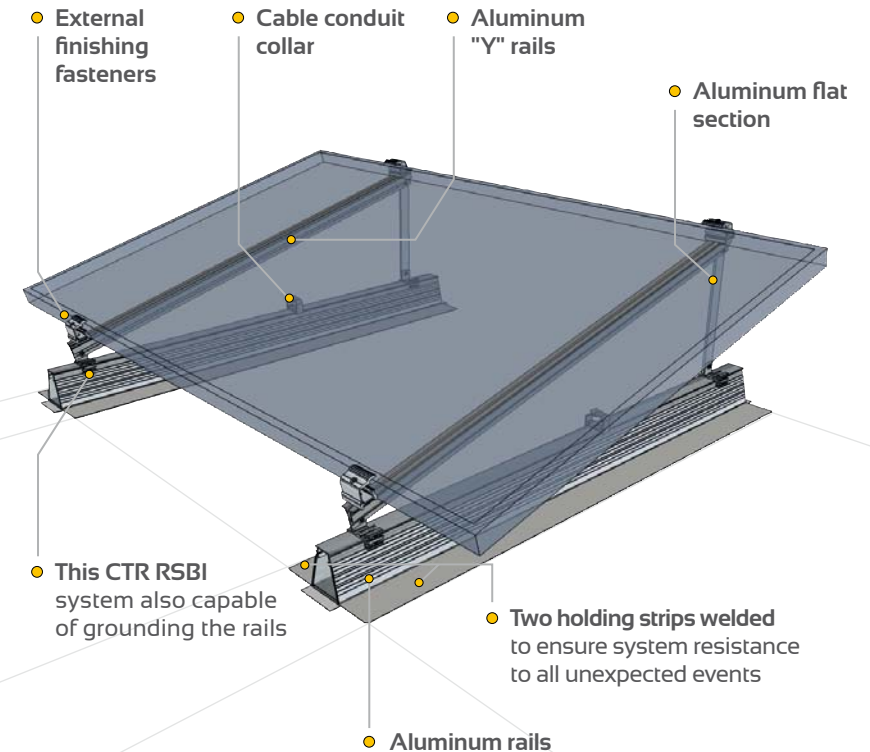

### TECHNICAL CHARACTERISTICS

<b>USE CONDITIONS</b>	An entirely closed building, new or renovated
<b>TYPE OF SUPPORT</b>	Corrugated steel sheet. Insulation with a "C" compressibility. Waterproofing synthetic coating in PVC (min 1.5 mm)
<b>MODULE POSITION</b>	Landscape
<b>MATERIALS</b>	Aluminum, stainless steel and PVC
<b>SYSTEM WEIGHT, WITH WELDED BITUMEN BANDS (EXCLUDING MODULES AND WATERPROOFING)</b>	4.7 kg/m <sup>2</sup>
<b>SYSTEMS COMPONENTS</b>	1.2m aluminum rail, welded bitumen bands, flat section (for a 15° tilt), "Y" rail, external finishing fasteners in aluminium and stainless steel.
<b>OPTIONS</b>	Module Grounding Connector (MGC) and a cable guide